

GoodWe HomeKit Application



GoodWe HomeKit is a solution designed to monitor load energy consumption in real time, 24 hours a day. Based on best design principles, the HomeKit is tailored to homeowners' needs and only requires an internet connection. It consists of a smart meter and a Wi-Fi / LAN communication module. An additional advantage of GoodWe HomeKit is that it can be applied to grid-connected systems with inverters of any brand or even systems without PV and it is a key component in keeping load consumption records. With 60-second update frequency, data is transmitted by Wi-Fi / LAN and stored on the cloud. End users benefit from a better understanding of their electricity consumption and the source from which it is generated. Moreover, if used together with a GoodWe inverter, HomeKit can limit the power exported to the grid.



24/7 Real-time
Consumption Monitoring



Export Power
Control



Work with Inverters
of Any Brand



Double CT Design - Super
Accurate Measurement



Can be Utilized in
Households without PV

24-Hour Real-time Consumption Monitoring

HomeKit offers 24-hour real-time consumption control. With the assistance of GoodWe monitoring platform, HomeKit can calculate self-consumption levels per day, month or year, providing a comprehensive overview of load consumption and the general efficiency achieved in the use of solar energy. Furthermore, the power consumption of the HomeKit itself is negligible, saving on additional electricity costs.

PV Generation: 15.1 kWh

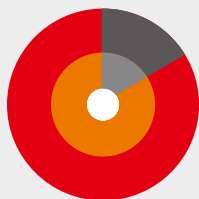

- Use of PV for self-consumption (83.4%)
- Energy exported to the grid (16.6%)

Loads Consumption: 38.7 kWh

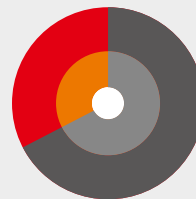

- Use of PV for self-consumption (32.6%)
- Energy imported from the grid (67.4%)

Export Control and Consumption Monitoring solution

HomeKit 1000 can do both export control and load consumption monitoring simultaneously on GoodWe single phase inverters.

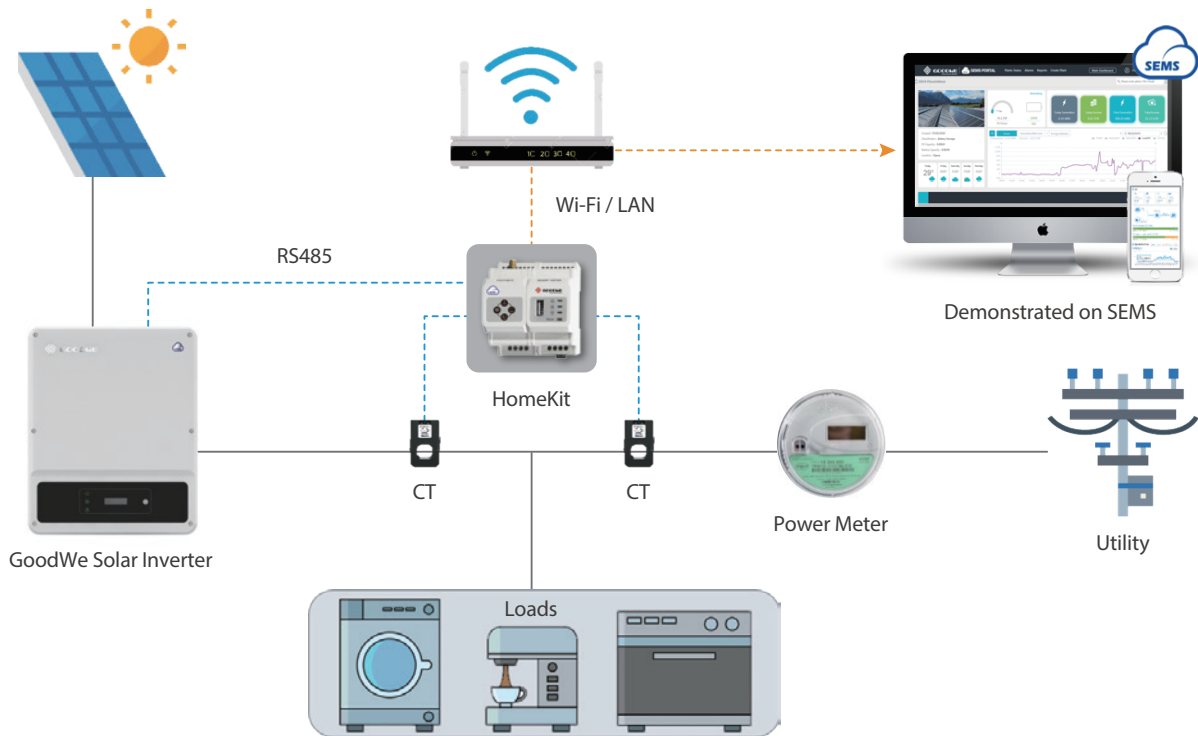

- This solution is only for GoodWe single phase inverter (NS, DNS, MS).
- For connecting HomeKit 485 port to inverter export control port refer to the picture above.
- HomeKit with two CTs 2meters length each allow max 120A pass through.
- HomeKit can work with any brand of inverter for consumption monitoring but will only work with GoodWe single phase inverters for export limit.
- For consumption monitoring, HomeKit must be connected to the internet as per the Wi-Fi manual on the HomeKit.
- To achieve export limit via HomeKit, the same procedure as CT90 is required; by pressing the button on inverter to start configuration.

MODEL		HK1000
Application		Household Loads Monitoring
Voltage	Rated Voltage	110V, 230V
	Voltage Range	100Vac~240Vac
	Frequency	50Hz/60Hz
Current Input	Rated Current	CT in: 120A/40mA
	Current Range	0.48A~120A
Self-consumption		<5W
Data Detection		Active Power/Reactive Power/Power Factor/Frequency
Energy Calculation		Active/Reactive Power Energy
Precision	Voltage/Current	Class 1
	Active Power	Class 1
	Reactive Power	Class 2
Communication		Wi-Fi or LAN
Interface		3 LED (Power, Energy Consumption, Communication), USB Port, Reset Button
Mechanical Parameters	Size (L*W*H)	36*85*66.5mm
	Weight	440g
	Protection Class	IP20 (For Indoor Use)
	Installation Method	Mounting Rack
Operating Temperature		-25 ~ +60°C
Operating Humidity		<95%, No Condensation
Altitude		<2000m